



SMOKE DETECTOR ASD-250



Fire hazard detection



ASD-250

SMOKE DETECTOR

Fast and reliable detection of the fire hazard is the basis for fire protection. Therefore, it is advisable that both residential and industrial buildings be equipped with a means of quick detection of visible smoke. An excellent solution to ensure a high level of fire protection is the ASD-250 smoke detector.

FEATURES:

- can work in standalone mode or as part of the ABAX or ABAX 2 two-way wireless system
- easy switching between detector operation modes
- loud acoustic signaling thanks to the type of piezoelectric transducer used
- dirt resistant thanks to the precise Hexamesh stainless steel filter
- quicker smoke detection thanks to the unique Swirl chamber
- auto-diagnostic functions: checking the status of battery and optical chamber
- remotely activated test mode (when used as part of the ABAX or ABAX 2 system)
- tamper protection against opening the enclosure (when used as part of the ABAX or ABAX 2 system)

- LED indication of test mode
- radio communication range in open area:
 - » ABAX 2: up to 2000 m
 - » ABAX: up to 500 m

TECHNICAL DATA:

- optical (LED) and acoustic (piezoelectric transducer) signaling of detected smoke
- volume level of piezoelectric transducer: min. 85 dB at a distance of 3 m from the detector
- operation in a temperature range from 0°C to 55°C
- compact enclosure with dimensions of $\varnothing 108 \times 54$ mm
- CR123A battery (up to 8 years' life*)

*within ABAX 2 (in ECO mode) depending on the detector's working conditions

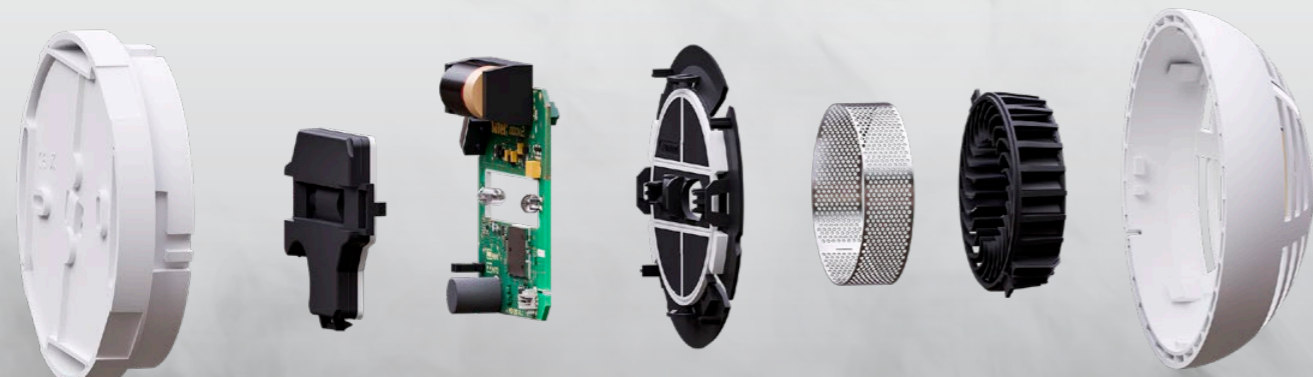

ASD-250 can operate in two modes: standalone or as part of the **ABAX 2/ABAX** wireless system

1

STANDALONE MODE

The ASD-250 detector is an ideal solution for small-size buildings, where a highly efficient level of smoke detection is to be ensured, without however creating a whole fire detection and fire alarm system.

This device meets the requirements of EN 14604 for stand-alone detectors, which is confirmed by a certificate issued by the Scientific and Research Centre for Fire Protection.



2

OPERATION AS PART OF ABAX 2/ABAX SYSTEM

ASD-250 can also work as part of the ABAX or ABAX 2 system. If the system includes a number of such devices and smoke is detected by one of them, the information can be transmitted by the controller to other ASD-250 detectors, which will trigger acoustic and optical alarm in them. Such a solution will greatly speed up the response time when a danger occurs, especially if the individual detectors are positioned, for example, in areas located on different floors.

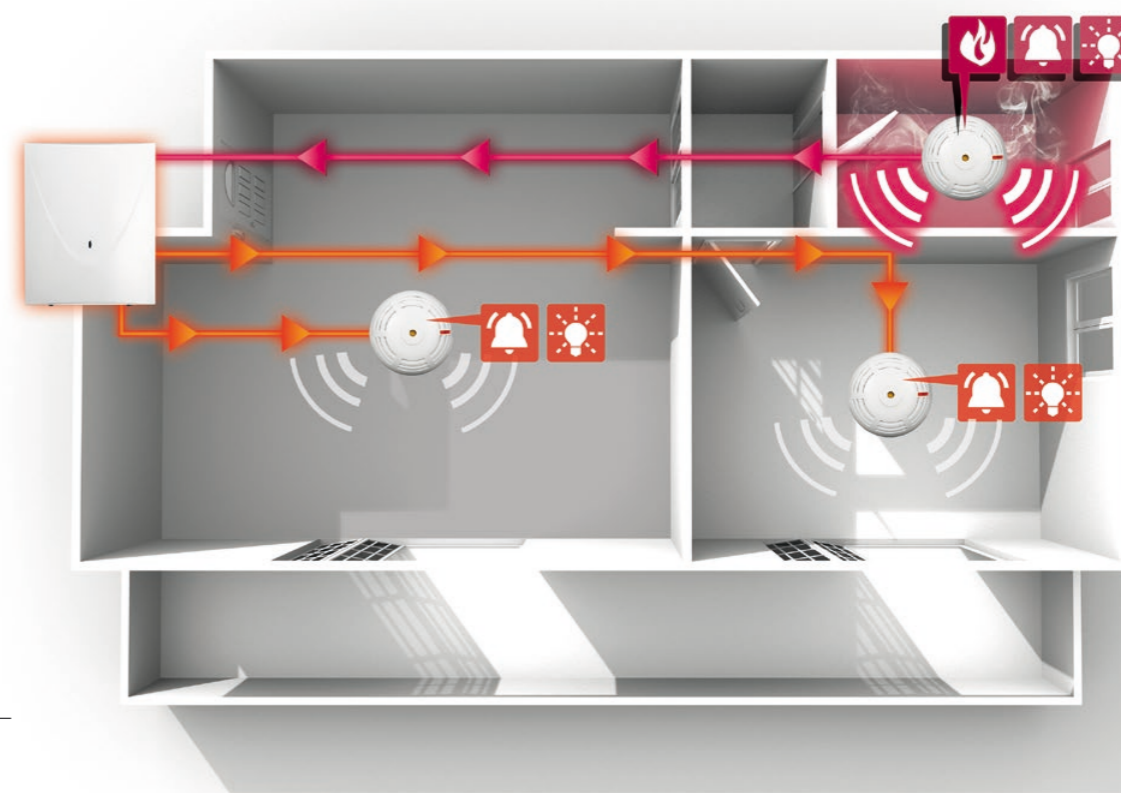



ul. Budowlanych 66, 80-298 Gdansk, Poland
tel. +48 58 320 94 00; fax + 48 58 320 94 01
e-mail: trade@satel.pl

www.satel.pl

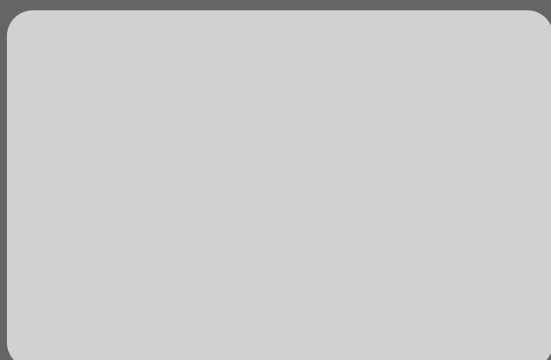

The manufacturer reserves the right to change the specification and technical data of devices.
Images shown are for general information only and may differ from actual products.
U-ASD250-EN0723

30 YEARS OF EXPERIENCE

Professional protection of each type of premises, as well as people staying therein, through advanced, yet functional and cost-effective solutions – these few words may serve as the shortest description of the mission of SATEL, a manufacturer of security systems with involvement of 100% Polish capital. Due to integrity in business and a special emphasis on high quality and a wide range of products offered, the SATEL brand has been highly appreciated in the industry for 30 years.

This philosophy of management and hard work of more than 350 SATEL's employees produce tangible results. The wide range of over 400 offered products provides countless opportunities to create security, home automation, fire alarm, access control and monitoring systems, tailored to the individual needs of each user. At the same time, these systems meet all requirements prescribed by Polish and international regulations and industry standards.

Bringing the functionality of devices into line with current requirements and expectations of the market with the use of the latest technologies is one of the main objectives of SATEL. For this reason the design and production departments of the Company are continuously being modernized and expanded. A natural consequence of all actions aimed at the production of top-quality devices was the introduction of the quality management system conforming to ISO 9001 in 2002. Regardless of this certification, SATEL also carries out a full functional test of all products leaving the production line, thus ensuring reliability of the manufactured devices. Focusing on modern design and attaching importance to the highest levels of quality and functionality of its products, SATEL has gained many satisfied customers not only in Poland but also in more than 50 markets worldwide.